

FLP05-***i-D

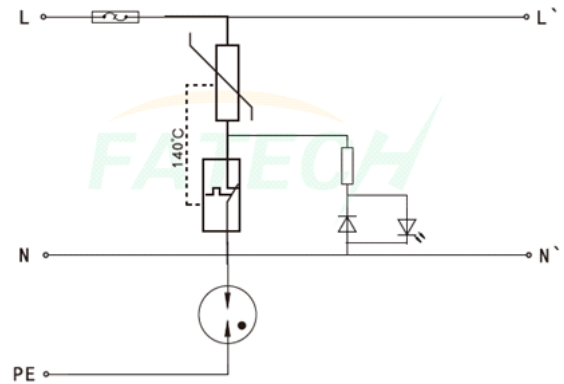

- ◆ New designed series connected surge protection module, Type 2 (or 3) LED surge protector. Compact design.
- ◆ Specifically for outdoor and commercial LED lighting applications, LED signage and traffic light manufacturers, including roadway lighting, parking garage lighting, wash wall lighting, traffic lighting, flood lighting, digital signage, street lightning, and tunneal lighting.
- ◆ I_{max} 15kA lightning surge protection.
- ◆ Varistor with built-in temperature tripping protection
- ◆ Equipped with overload protection. Power supply disconnected when failure occursv
- ◆ State indication
- ◆ DIN rail installation

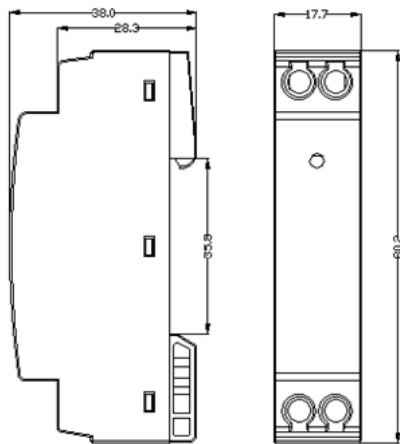

Model No.	FLP05-150i-D	FLP05-275i-D	FLP05-320i-D	FLP05-385i-D	
Test class IEC/EN/VDE	Class II+III/C+D/ <u>T2</u> <u>T3</u>				
Type of Network	LED street light				
Nominal voltage 50(60)Hz UN	120V~	230V~	230V~	230V~	
Rated Voltage (Max. Cont. Operating Voltage) UC	150V~	275V~	320V~	385V~	
Max. discharge current (8/20μs) I _{max}	15kA				
Nominal discharge current (8/20μs) I _n	5kA				
Voltage protective level Up	L-N	≤0.8kV	≤1.3kV	≤1.5kV	≤1.8kV
	N-PE	≤0.5kV	≤0.5kV	≤0.6kV	≤1.0kV
	L-PE	≤1.5kV	≤1.5kV	≤1.8kV	≤2.0kV
Open circuit voltage U _{oc}	10kV				
Response time t _A	L-N: ≤25ns, N-PE ≤100ns				
Recommended back-up fuse	20A				
Thermal Cut-off Member	Internal				
Disconnection indicator	LED indicator				
Protection Mode	L - N, N - PE, L - PE				
Wire length	150mm				
Operation temperature range / altitude	-40°C~+80°C / 3000m				
Degree of protection	IP				
Housing material	UL94 V-0				